

# JOHN MARSHALL HIGH SCHOOL

- |                       |   |
|-----------------------|---|
| Principal             | P   |
| Assistant Principal   | AP  |
| Assistant Principal   | AP  |
| Attendance Office     | A   |
| Custodian             | C   |
| Dean of Boys          | DB  |
| Dean of Girls         | DG  |
| DCE Coordinator       | 101   |
| Faculty Room          | 130   |
| General Office        | Gen. O.   |
| Guidance Director     | G   |
| Nurse                 | N   |
| Stage Craft           | 117   |
| Study Hall            | 139   |
| Art Dept.             | Art, 150, 152, 154  |
| Athletic Dept.        | AT, Boys' P.E.<br>Girls' F.E., 105,<br>106, 160, 202, 204 |
| Business Dept.        | B, 140, 142, 144,<br>145, 146, 147                        |
| Home Economics Dept.  | HE, 119, 123,<br>168, 170, 172,<br>174                    |
| Industrial Arts Dept. | IA, 153, 155,<br>156, 157, 158,<br>159                    |
| Music Dept.           | M, 160, 162,<br>164, 166                                  |
| R.O.T.C.              | R, 149, 151   |

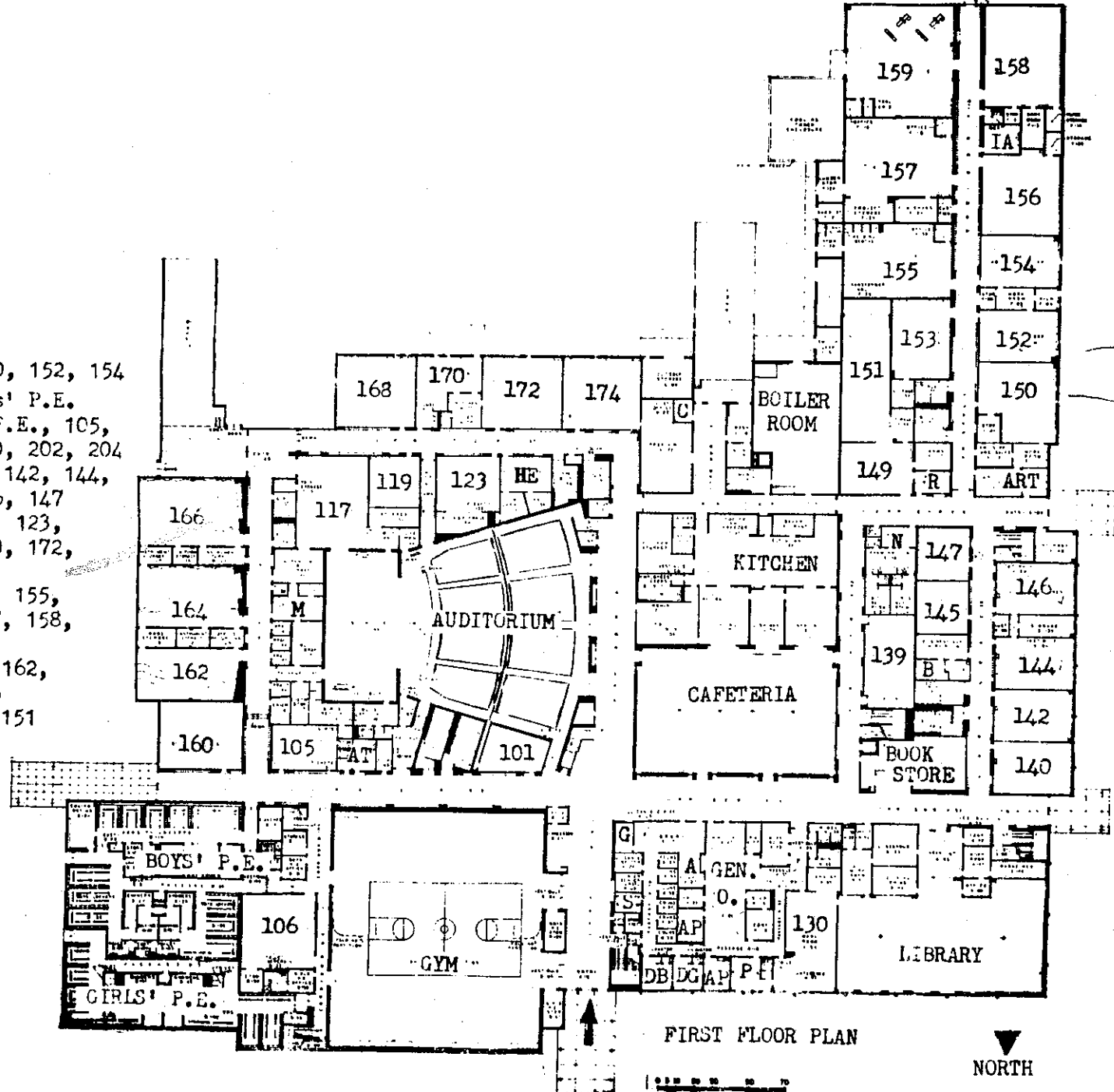

FIRST FLOOR PLAN

NORTH

English Dept.	E, 206, 224, 225, 226, 227, 228, 229, 230, 232, 234, 236, 238
Foreign Language	FL, 209, 210, 211, 212, 213
Lecture Room	254
Math Dept.	Math, 255, 256, 257, 258, 260
Science Dept.	SO, 240, 241, 242, 243, 244, 246, 248, 249, 250, 250A, 251
Social Studies	SS, 214, 216, 218, 220, 222
Study Hall	208

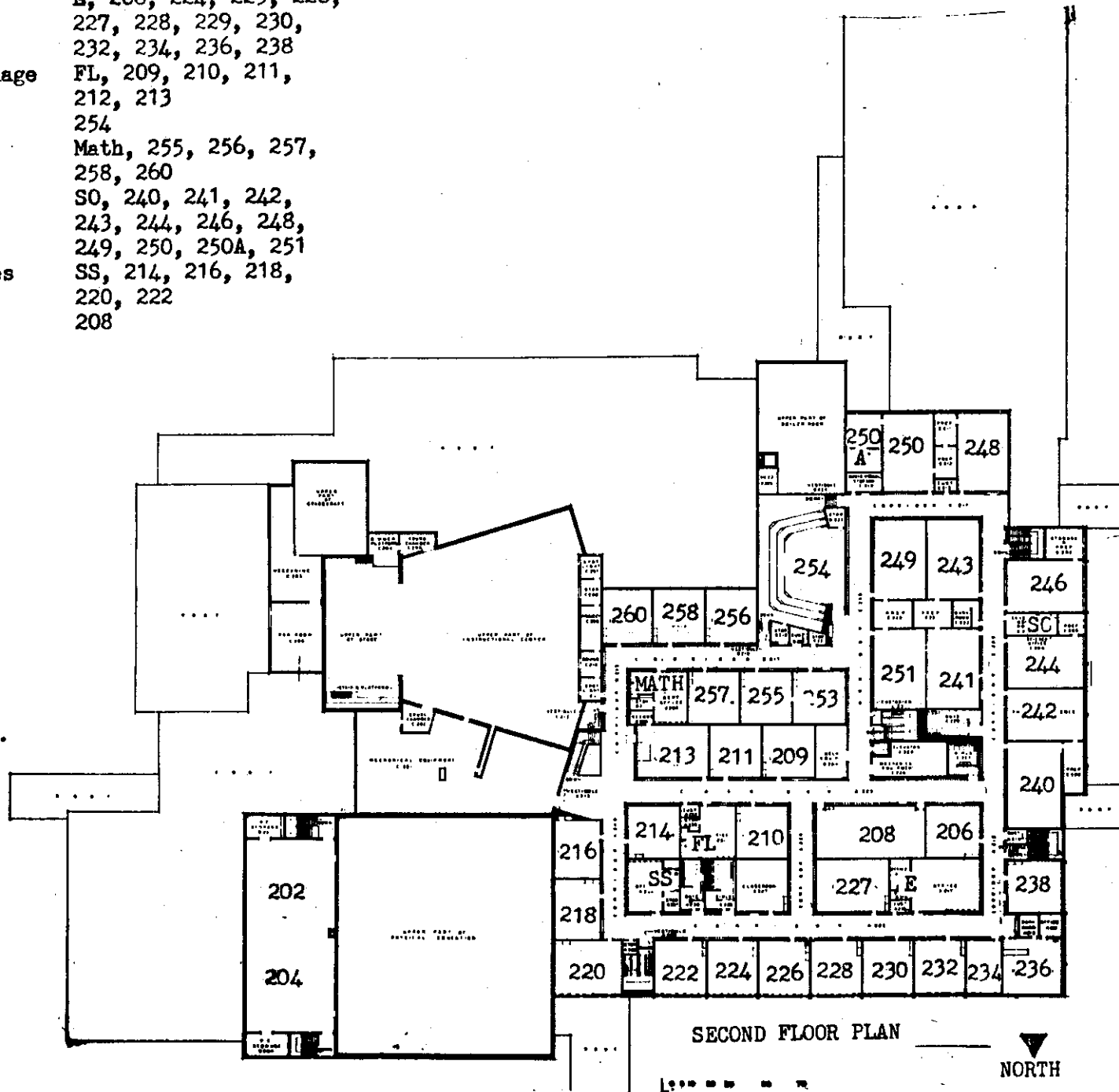

SECOND FLOOR PLAN



NORTH

JOHN MARSHALL JR. HIGH SCHOOL

1975 ADDITION

CEILING TILE LOCATIONS (MISC)

(NOTE: NOT DRAWN TO SCALE)

POSITIVE LOCATIONS IN BLUE

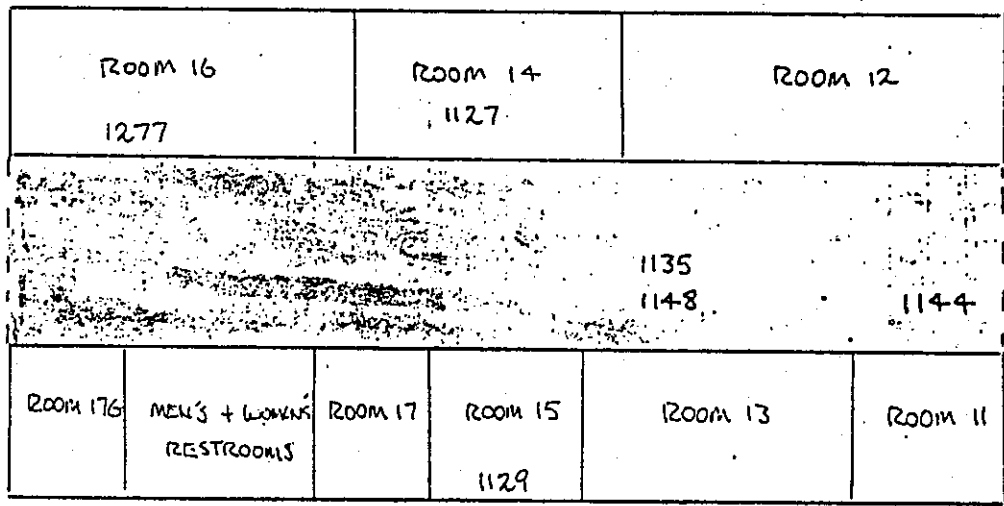

W ≈ 10'

L ≈ 200'

